

CUSHMAN SAWMILL, INC.

P.O. Box 156
Evening Shade, AR 72532

Sawmill Location:
2465 White Dr.
Batesville, AR 72501
Business Office: 870-698-0128
www.scragsmill.com

SCOTT R. CUSHMAN
PRESIDENT



BUYER OF LOGS AND STANDING TIMBER

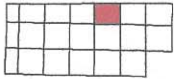

Township 21N - Range 7W

Copyright © 2015 Mapping Solutions

HOWELL COUNTY, MISSOURI

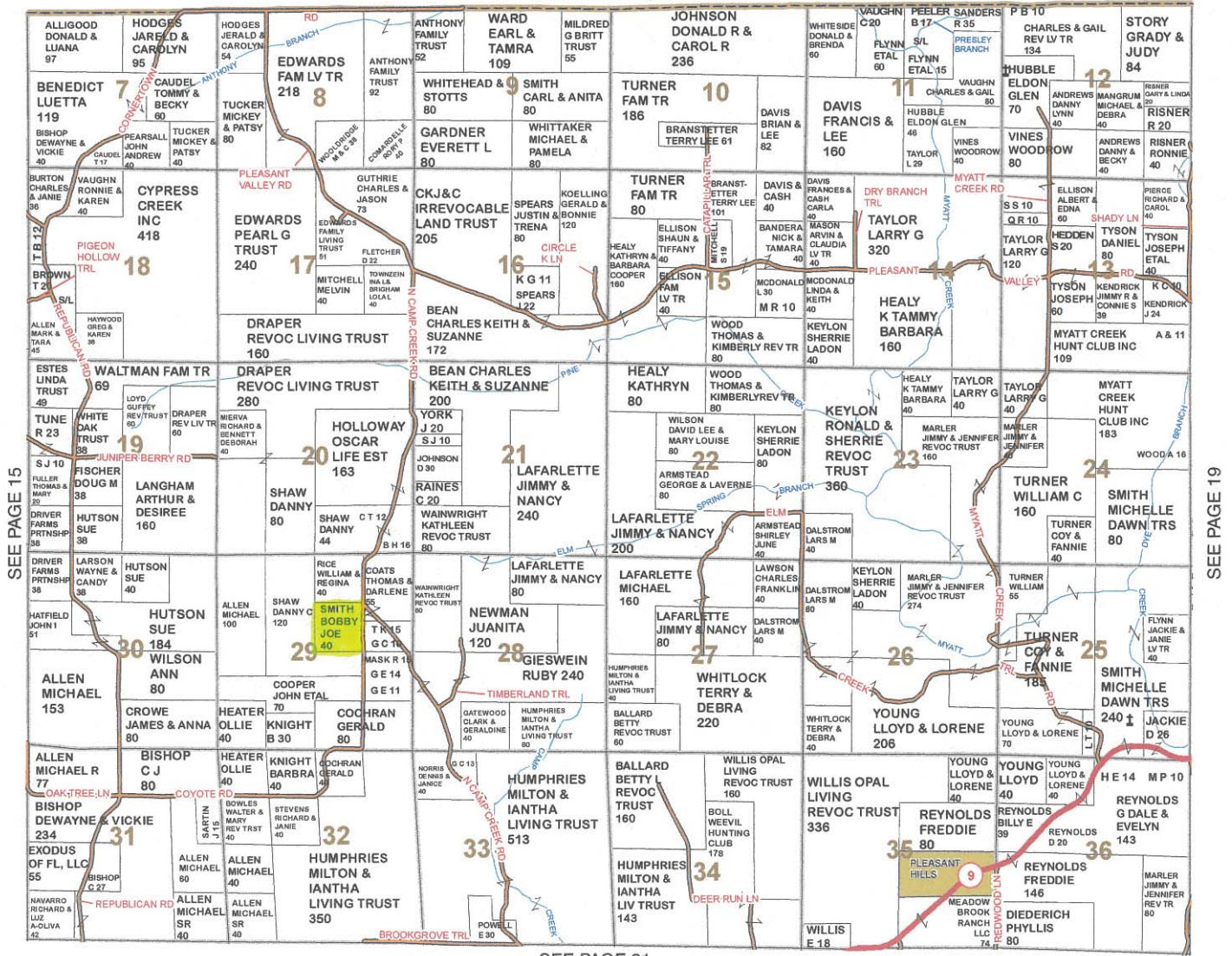

SEE PAGE 19